

# INSTALLATION INSTRUCTION FOR FC-F119 PUSH/PULL LATCH

## NOTES:

1. Trim can be mounted up, down, horizontally or vertical or in any combination ★★.
2. Uses standard 161 door prep.
3. Vision lite must be at least 6" from latch prep.

ITEM	QTY	PART DESCRIPTION
1	2	COVER
2	4	5/32"-32 X 3/8" SCREWS
3	4	1/4"-20 X 2-15/32" SCREWS
4	1	PUSH SIDE HANDLE
5	2	#8 X 3/4" SCREWS
6	1	LATCH FOR 2-3/4" BACKSET
6-1	1	LATCH FOR 5" BACKSET
7	1	PULL SIDE HANDLE
8	4	1/4"-20 HEX LOCK NUT

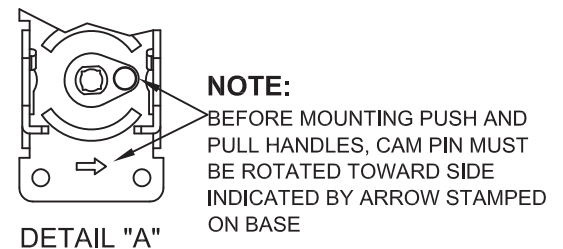
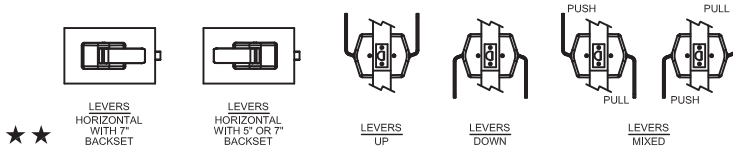
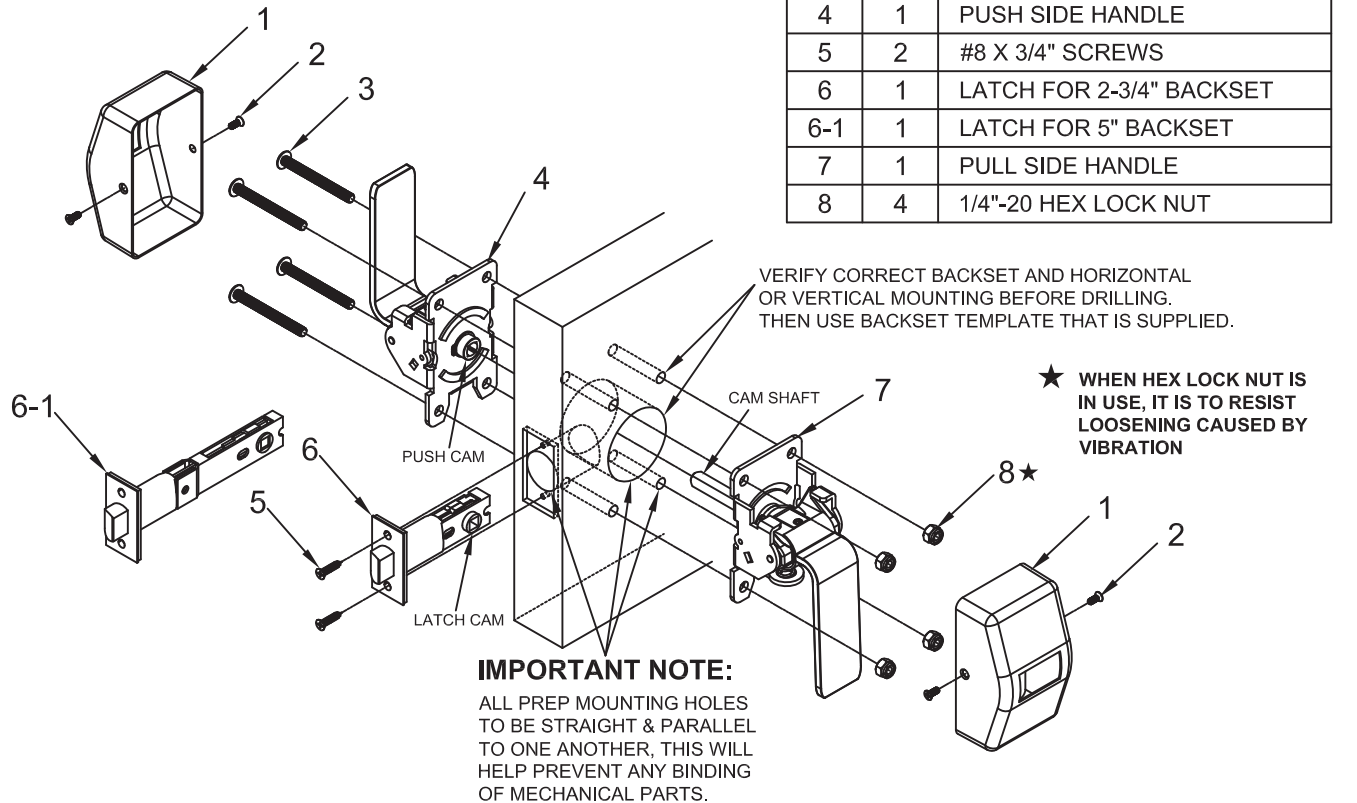

## INSTALLATION INSTRUCTIONS:

1. Prep door according to latch backset and determine if trim is to be mounted horizontal or vertical mounting using backset template.
2. Install latch using either wood or machine screws (item 5) depending on door type.
3. Assemble trim.
  - A) Test both handles to determine which is the push or pull type.
  - B) Select the pull trim first. With trim in hand, rotate the cam assembly until the cam pin stops on the appropriate side indicated by the arrow (see detail "A"), same for push trim.
  - C) Place pull side handle on pull side of the door and slide cam shaft through the latch cam. Then place the push side handle on the push side of the door engaging the push cam onto the pull side cam shaft. Fasten by hand both trim handles with (4) 1/4"-20 x 2-15/32" machine screws (item 3) with (4) 1/4"-20 Hex Nuts (item 8). test both trim handles for free movement of the latch bolt before tightening all screws. If latch bolt does not extend or retract freely because of any type of binding, loosen mounting screws to adjust alignment of trim handles and retighten screws one at a time while checking latch bolt movement from both handles.
  - D) Test lock for proper operation and check that the mounting hardware (item 3) & (item 8) IS TIGHT before proceeding with the next step.
  - E) Place covers (item 1) over push/pull trims and secure with (2) flat head screws (item 2) on each cover