

# INSTALLATION INSTRUCTION OF HOSPITAL LATCH FOR PRIVACY FUNCTION

1. Insert Latch Bolt into preps hole and fastened with two #8x3/4" screws.

Privacy Door  
-Outside

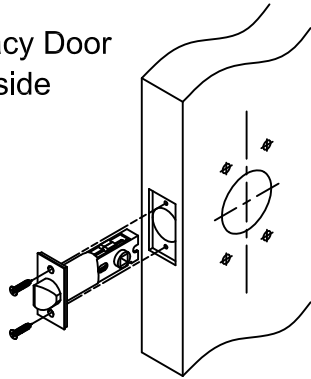

Privacy Door  
-Inside

- 2-1. First, insert 8mm spindle into Latch Bolt square pinion hole.  
2-2. Second, mounting the inner portion of push/pull chassis onto the Privacy Door inside panel and flush. Make sure the 8mm square spindle and chassis center square hole is joint.

Privacy Door  
-Outside

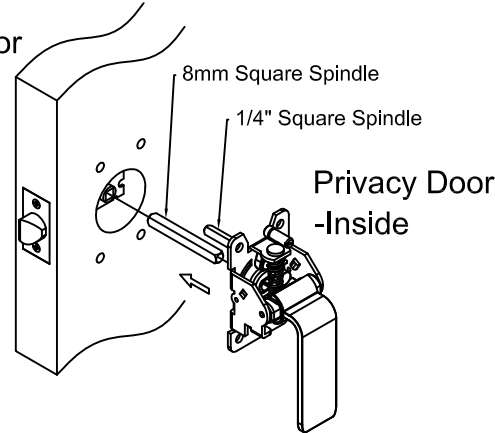

Privacy Door  
-Inside

- 3-1. First, placing the outer portion of push/pull chassis onto the both 8mm and 1/4" square spindle and flush to panel.  
3-2. Second, rotate the 1/4" square spindle to the same orientation as the "indicator pinion" to be install, insert the indicator pinion onto the 1/4" square spindle and fastened with screw.

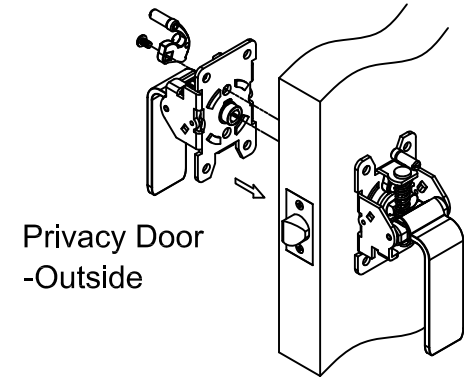

Privacy Door  
-Outside

Privacy Door  
-Inside

Privacy Door  
-Outside

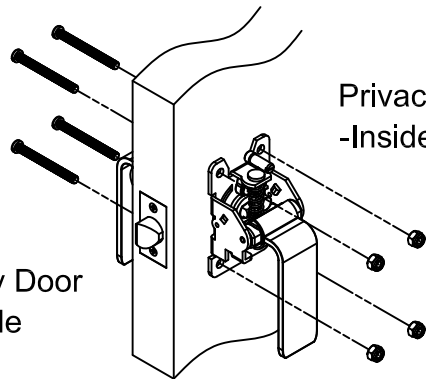

Privacy Door  
-Inside

4. Make sure both inner and outer push/pull chassis's are flush to door panel, and inserts all four 1/4"-20x2-15/32" screws onto 4 bolt through holes from outer chassis and fastened with 4pcs 1/4"-20 hex hex nuts on inner chassis.

Privacy Door  
-Outside

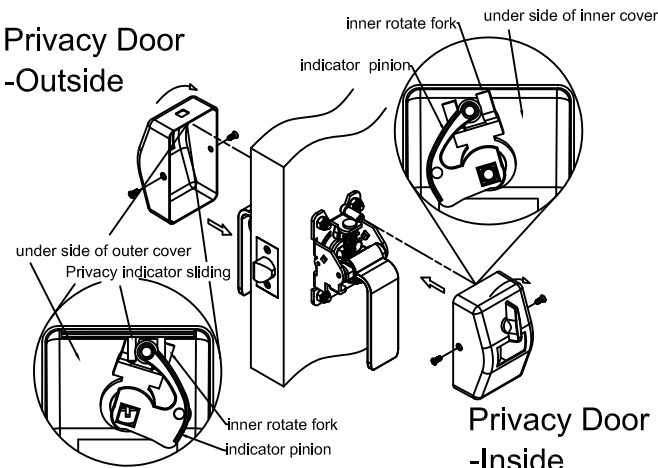

Privacy Door  
-Inside

- 5-1. Rotate the inner cover thumbturn to the correct orientation before mounting the inner cover onto inner chassis.  
5-2. Rotate the outer cover indicator pinion to the correct orientation before mounting the outer cover onto outer chassis.

Privacy Door  
-Outside

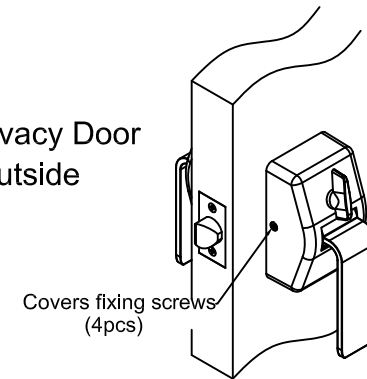

Privacy Door  
-Inside

6. Fastened both covers with screws as indicated on either sides of covers, total 4pcs and check the Privacy Indicator is correctly functions.

Covers fixing screws  
(4pcs)