

Luter Fire Command Exit Device

FC2100 & FC2300 Series Exit Devices
Grade 1 Concealed Vertical Rod Exit Device



LUTER PANIC HARDWARE

www.luter.com.tw

Fire Exit Hardware Selection

PAIR OF DOORS WITH MULLION

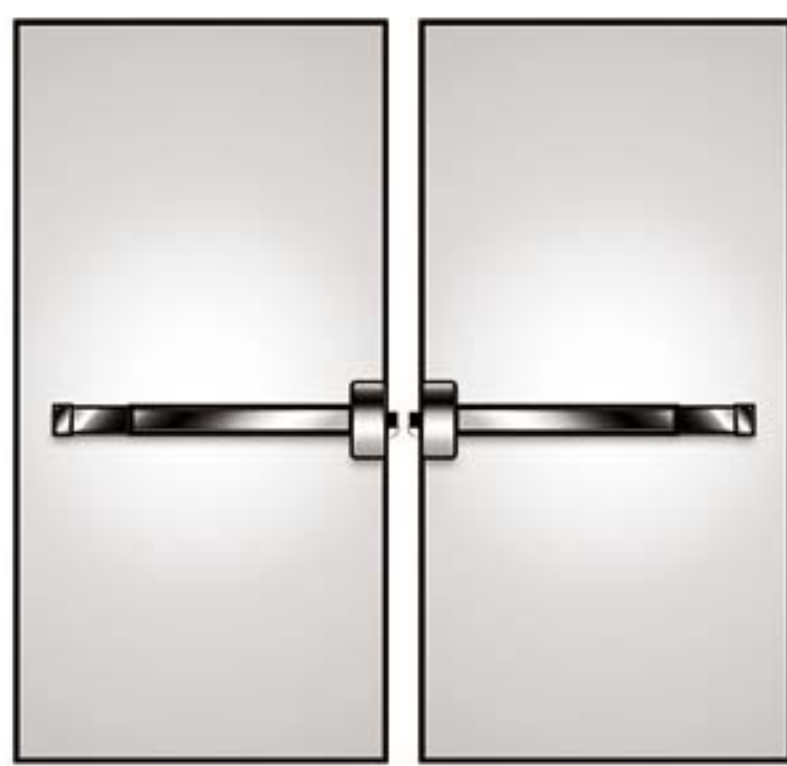

**2 Rim type
with mullion**

Two independent active doors with full double door openings when required. Same direction.

PAIR OF DOORS WITHOUT MULLION

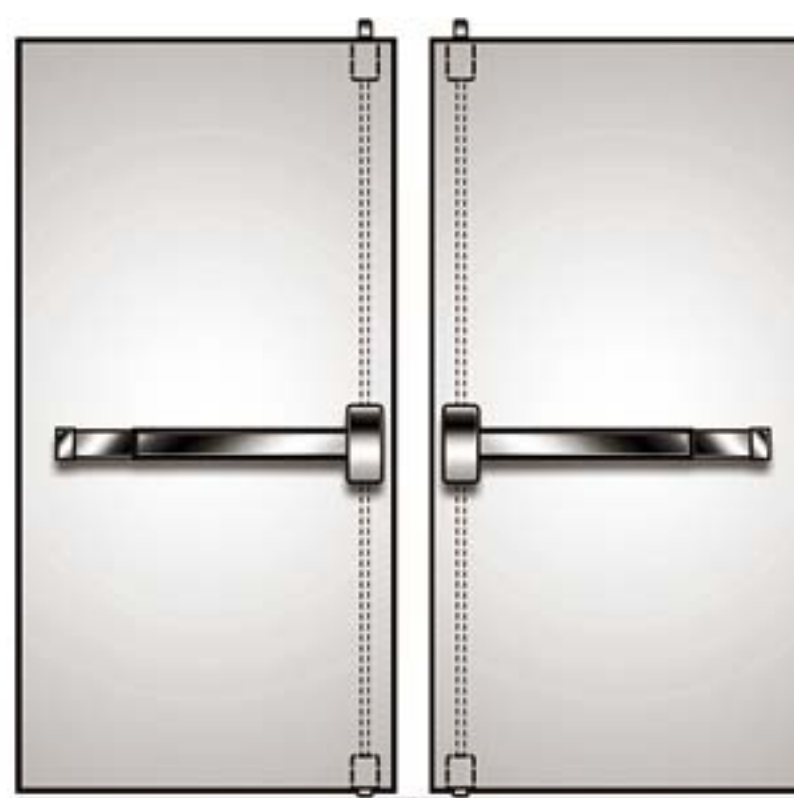

2 Vertical rod type

2 point locking both doors. Each door active same direction. Do not use with overlapping astragal.

PAIR OF DOORS WITHOUT MULLION

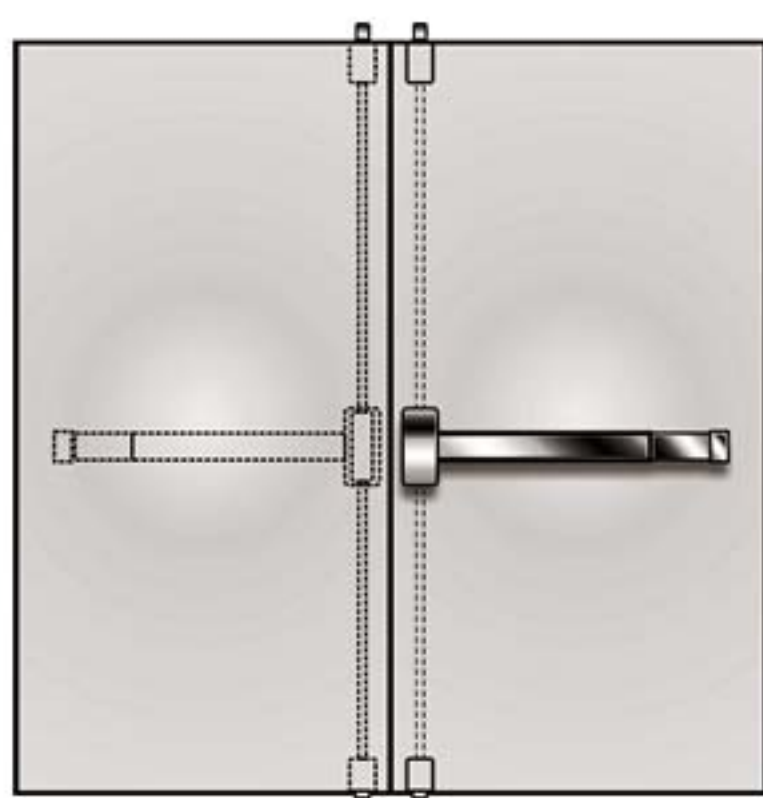

2 Vertical rod type

2 point locking both doors opposite direction.

PAIR OF DOORS WITHOUT MULLION

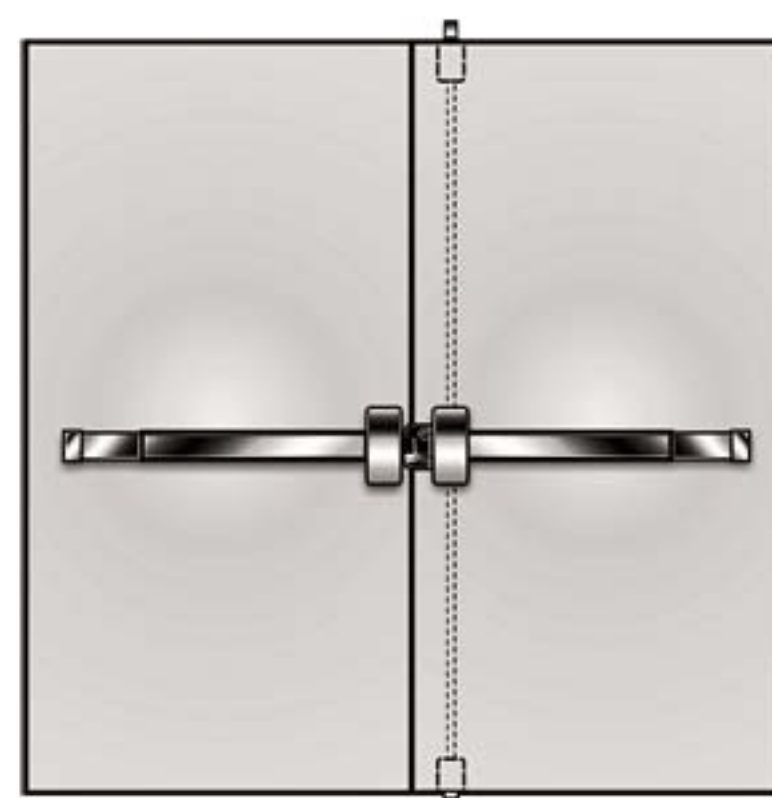

**1 Vertical rod and
1 Rim type**

A coordinator and overlapping stike is recommended.

SINGLE DOOR



**Vertical rod type or
Rim type**

Surface applied 2 point lock. Surface application.

HANDING

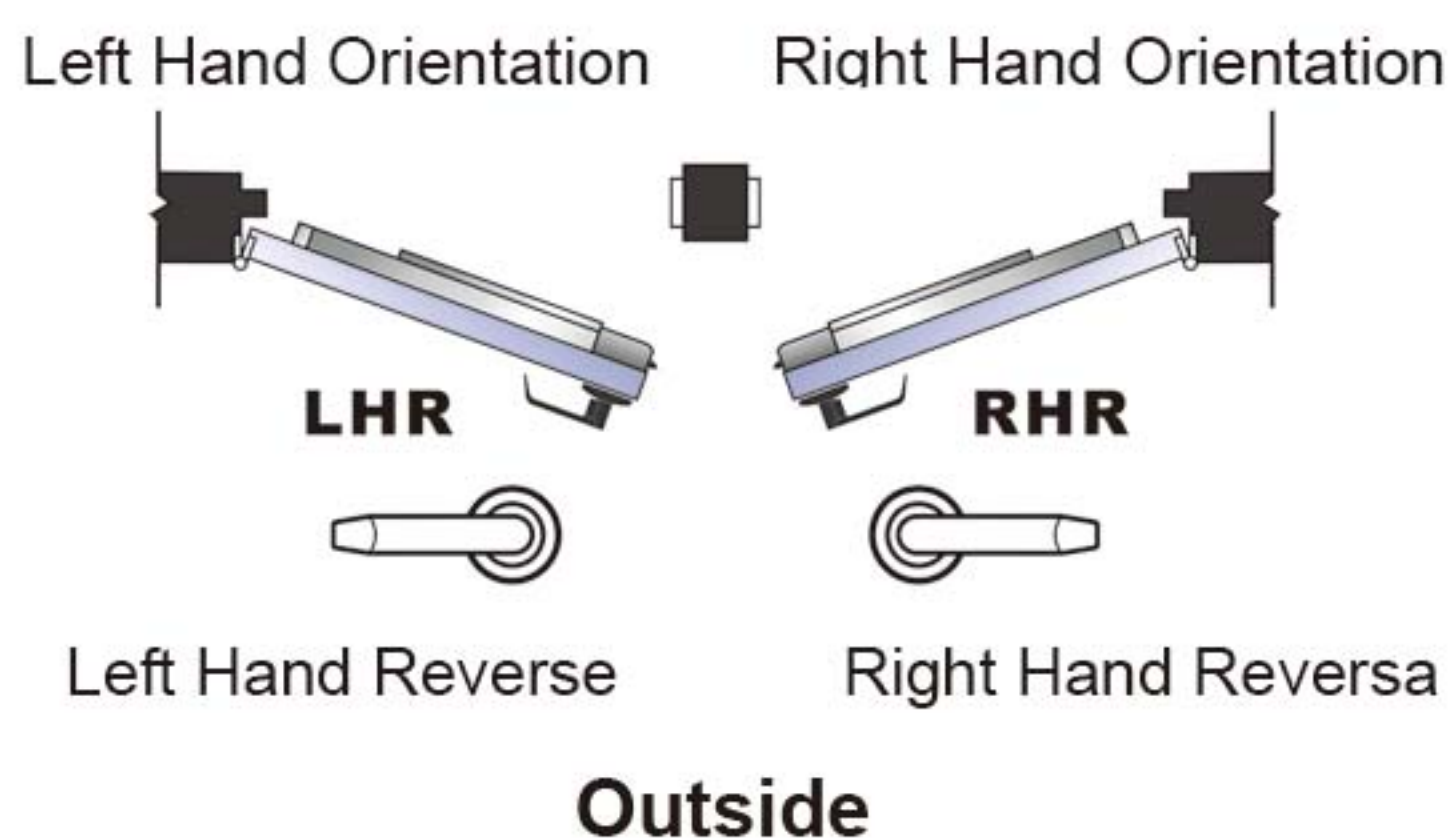

Luter Fire Command Panic Exit Device

FC2100 Series Exit Devices

Grade 1 Concealed Vertical Rod Exit Device

For Metal Doors

Specifications

For Doors	-----	Metal. 1-3/4" (44.5mm) minimum thickness 4-1/2" (114mm) minimum stile width
Chassis	-----	Nonferrous alloy
Cover	-----	Bronze or stainless steel
Mounting	-----	Furnished standard with machine screws.
End Cap	-----	Brass, Bronze or stainless steel Construction
Handing	-----	Easily field reversible. Specify at time of order LRHB, RHRB for convenience.
ANSI standard	-----	A156.3, Grade 1.
Strike	-----	260 top and 265 bottom
Top and bottom bolts	--	Stainless steel. Top and bottom bolt travel 7/16" (11mm) Projection adjustable up to 1" (25mm)
Fire Exit hardware	----	FC2100 Series for fire Exit hardware for all types of 8" x 8" double doors for up to 3 hour fire labeled installations, conforms to standards UL10C and UBC 7-2-1997 codes.
Rail height	-----	Specify door opening and mounting height of center line of rail ordering an vertical Rod Exit 41" from floor.
Trim	-----	See trim Designs section
Door size	-----	2100 3684 for 36" x 84" doors. Other sizes available on request 2100 3696 for 36" x 96" doors

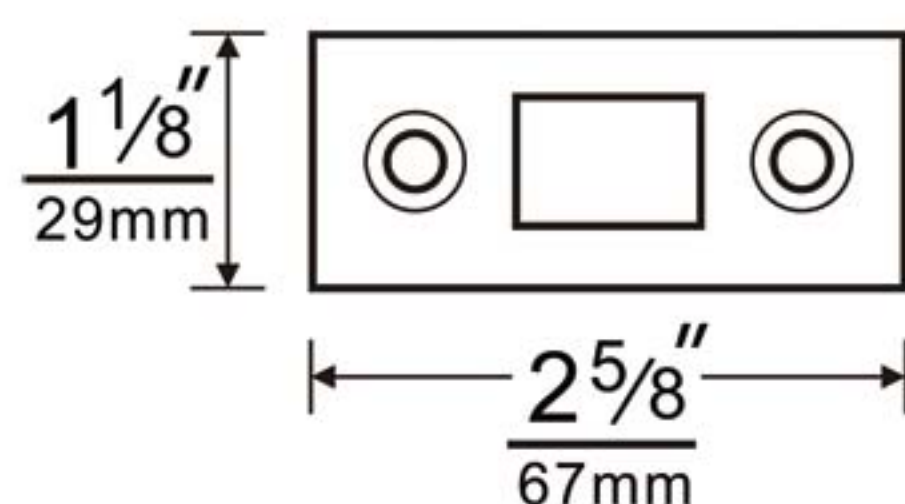
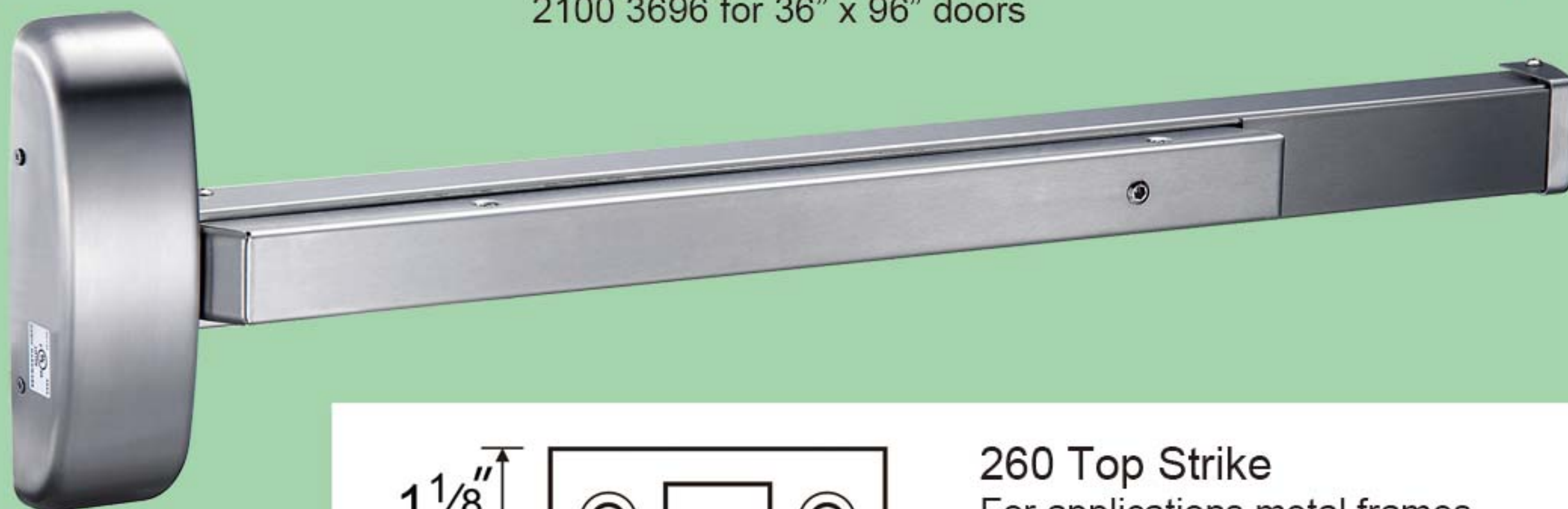
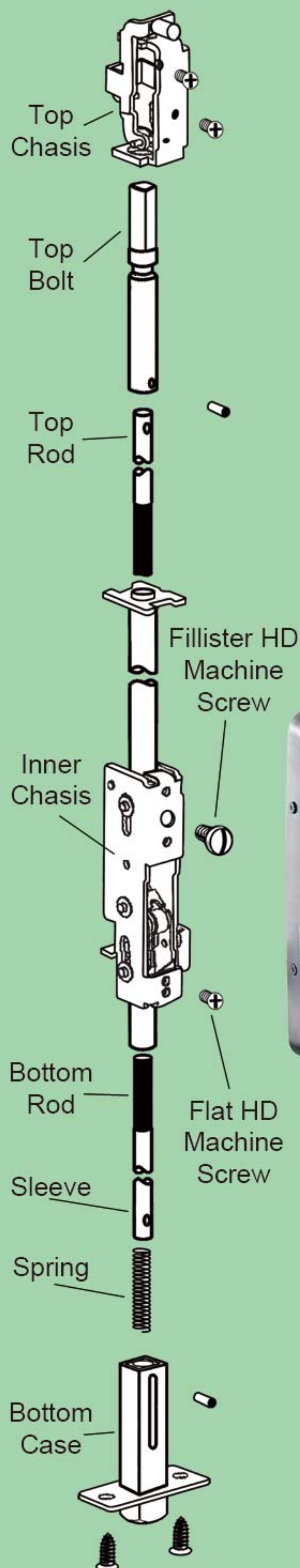

260 Top Strike
For applications metal frames
Stainless Steel

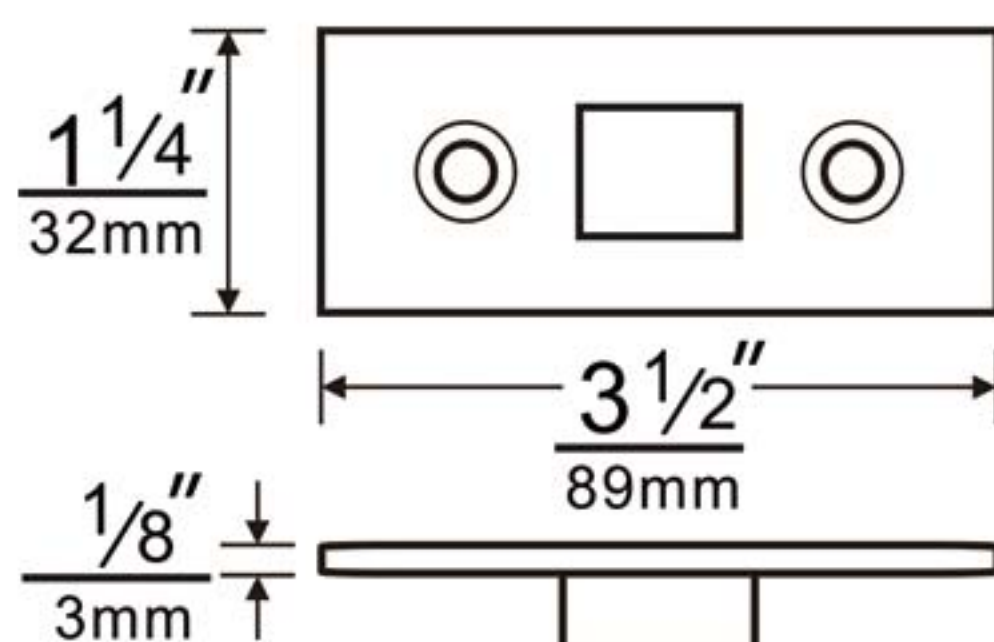

265 Bottom Strike
Furnished with expansion shields
Mortised into floor
Stainless Steel

Luter Fire Command Panic Exit Device

FC2300 Series Exit Devices

Grade 1 Concealed Vertical Rod Exit Device

For Wood Doors

Specifications

For Doors	Wood. 1-3/4" (44.5mm) minimum thickness 4-1/2" (114mm) minimum stile width
Chassis	Nonferrous alloy
Cover	Bronze or stainless steel
Mounting	Furnished standard with wood and machine screws.
End Cap	Brass, Bronze or stainless steel Construction
Handing	Easily field reversible. Specify at time of order LRHB, RHRB for convenience.
ANSI standard	A156.3, Grade 1.
Strike	260 top and 265 bottom
Top and bottom bolts	Stainless steel. Top and bottom bolt travel 7/16" (11mm) Projection adjustable up to 1" (25mm)
Fire Exit hardware	FC2300 Series for fire Exit hardware for all types of 8" x 8" double doors for up to 3 hour fire labeled installations, conforms to standards UL10C and UBC 7-2-1997 codes.
Rail height	Specify door opening and mounting height of center line of rail ordering an vertical Rod Exit 41" from floor.
Trim	See trim Designs section
Door size	2300 3684 for 36" x 84" doors. Other sizes available on request 2300 3696 for 36" x 96" doors

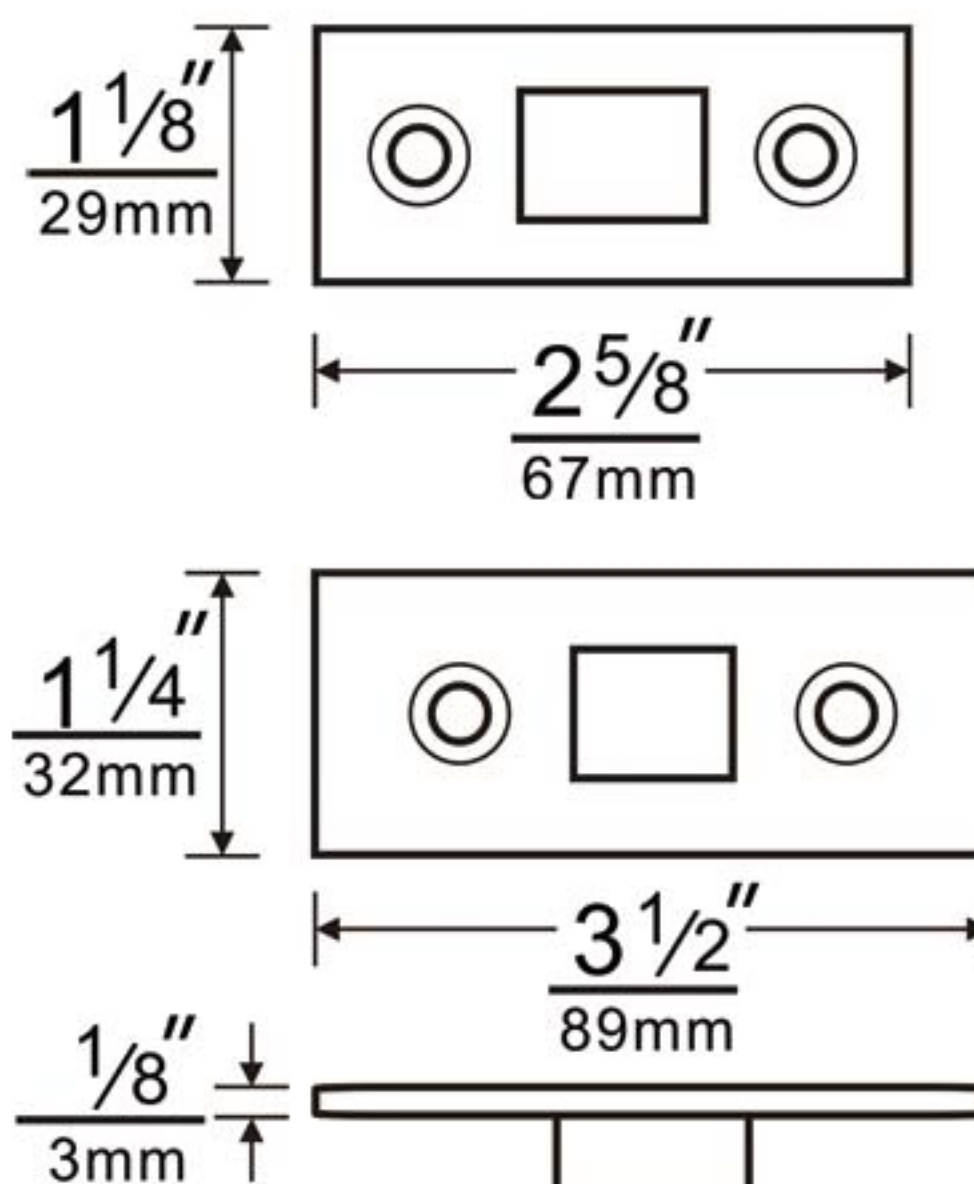
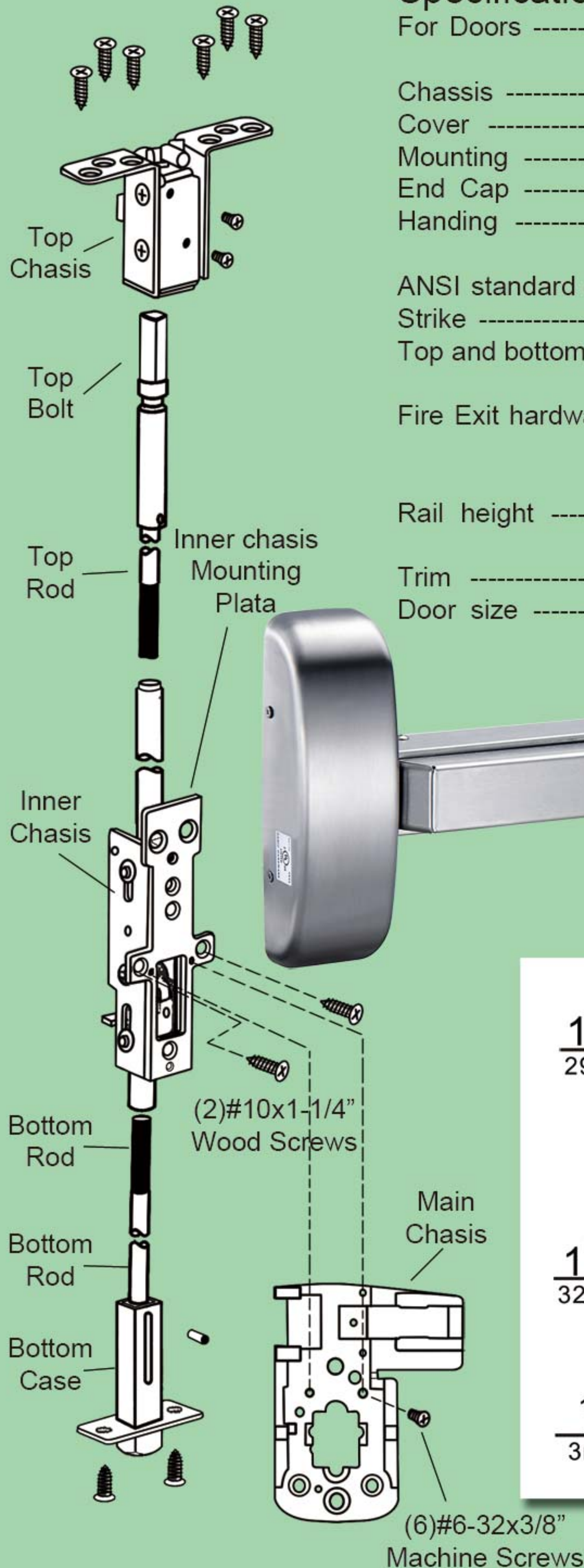

260 Top Strike

For applications metal frames
Stainless Steel

265 Bottom Strike

Furnished with expansion shields
Mortised into floor
Stainless Steel

Luter Fire Command Panic Exit Device
ESCUTCHON LEVER DESIGN
CVRESC for FC2100 / FC2300 Concealed Vertical
Rod Exit Device for Metal & Wood Doors

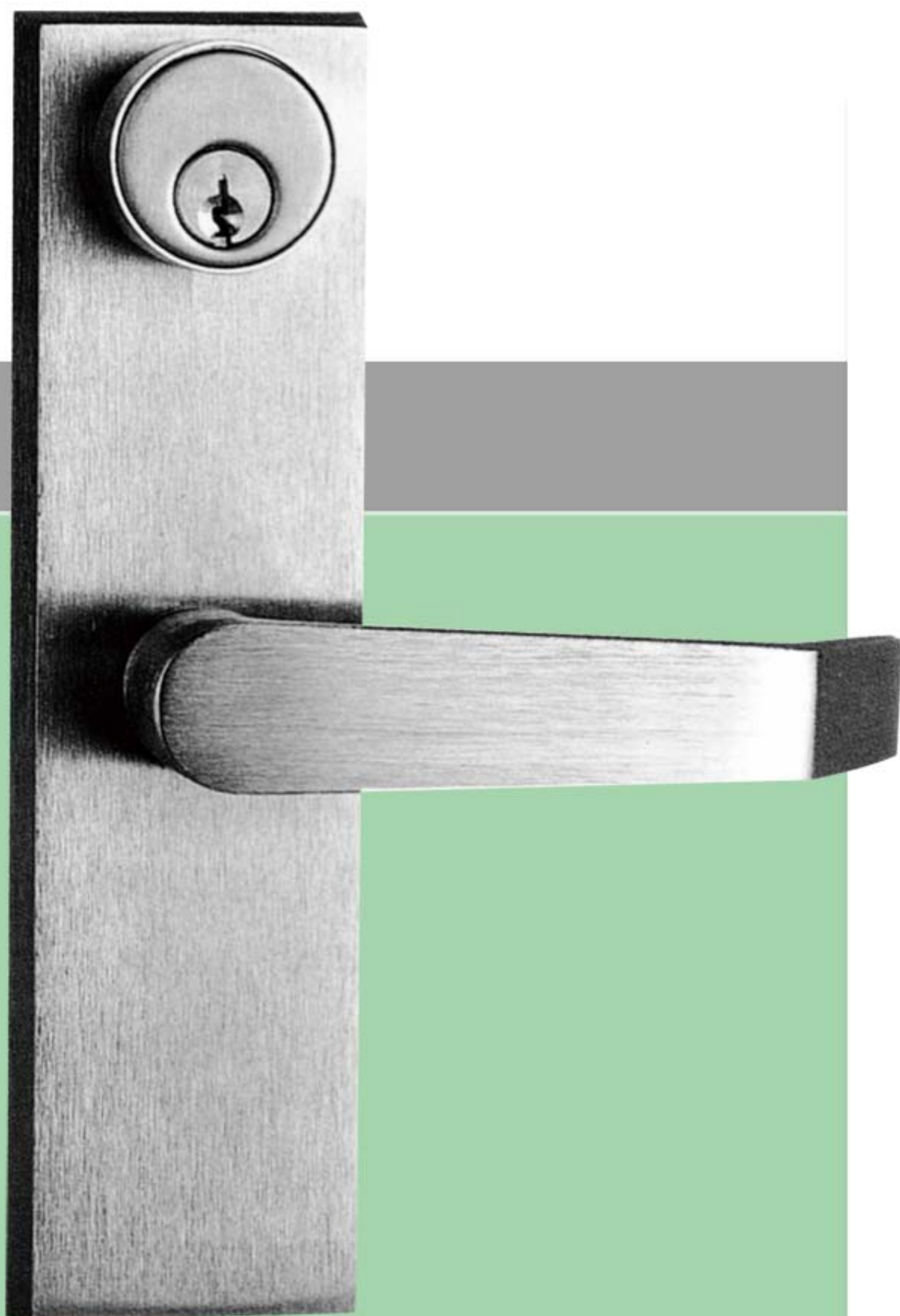

- Grade 1, thrubolted design, clutch freewheeling. Non-handed design. Easily field reversible.
- Hardened steel heavy duty tailpiece.
- Available for fire and non-fire rated rim and vertical rod exit devices.
- For 1 3/4" doors.
- 2-5/6" width, 8-1/2" length. Fits and covers 2-1/8" cutout.
- Finishes:
US26D, US10B, US3, US4.

Function

CVRESC-9800 Entrance ANSI Function – 13
Esc Lever Trim is lockable, lever locks or unlocks by key.

Keyway:

Standard 6-pin Schlage "C" keyway. Also available in Corbin 60, Sargent LA, and Mul-T-Lock high security cylinders.

CVRESC-9805 Storeroom ANSI Function - 04
Key remained on cylinder, unless locked.

CVRESC-9830 Passage ANSI Function - 15
Trim is always free.

CVRESC-9840 Dummy ANSI Function - 10
Dummy trim. One-sided

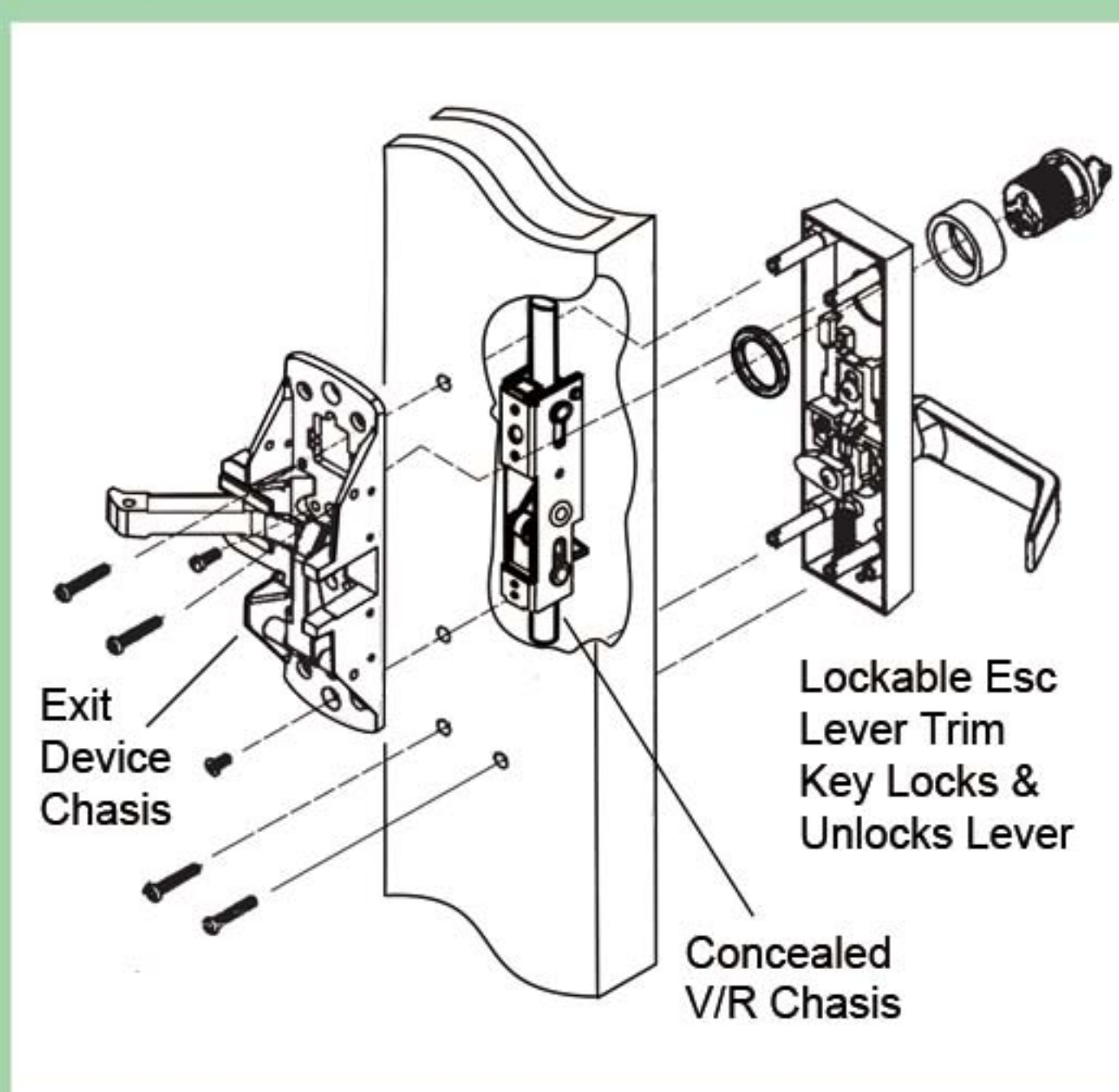

Lutér®
Architectural Hardware

Luter Enterprise Co.,Ltd.
No.59, Alley 6-6, Lane298, Beitun Rd., Beitun
District, Taichung City 406, Taiwan (R.O.C.)

TEL : +886-4-22479015
FAX : +886-4-22414361
www.luter.com.tw
e-mail : louischou@luter.com.tw