

INSTRUCTIONS FOR INSTALLING Luter FC-2200 SERIES MORTISE EXIT DEVICE

Available stock length

- For 32" doors, Device can be cut to fit doors down to 24" wide
- For 36" doors, Device can be cut to fit doors down to 32" wide
- For 48" doors, Device can be cut to fit doors down to 44" wide

THIS EXIT DEVICE IS HANDED
CHECK HAND OF DEVICE AGAINST APPLICATION

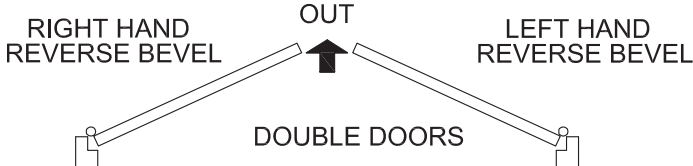

Door Surface must be flush
to allow Exit Device rest
on flat surface of the door

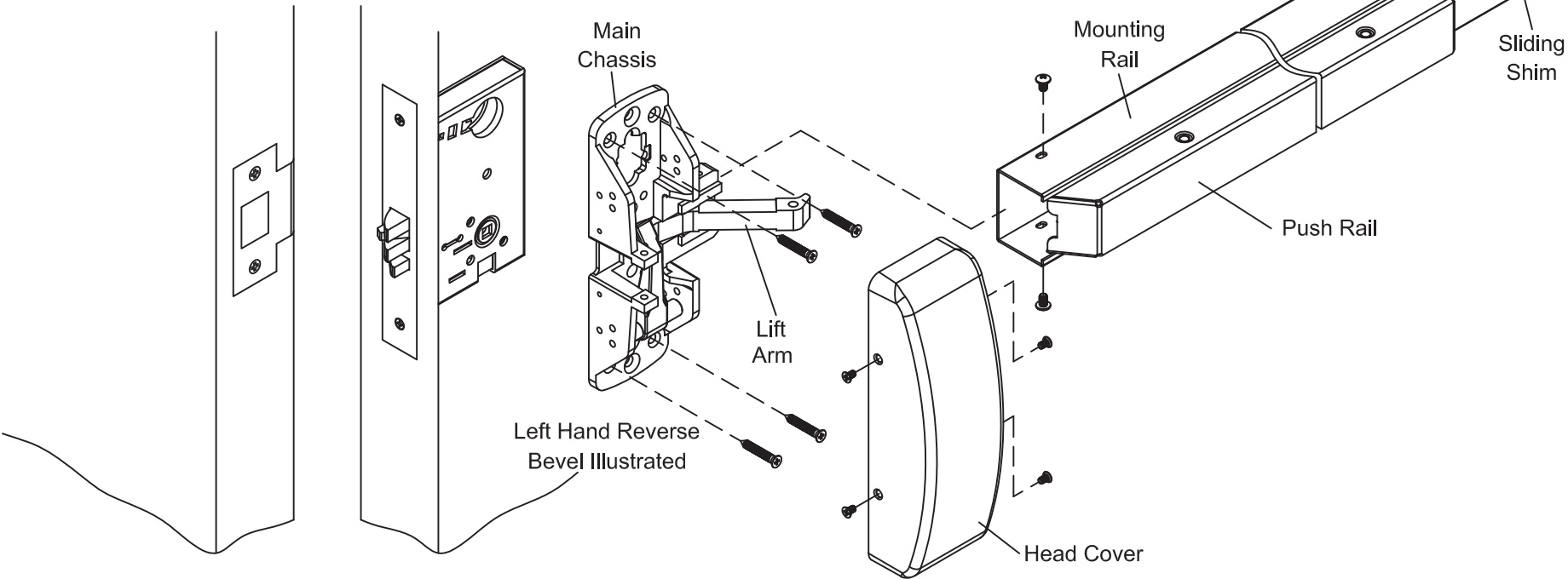
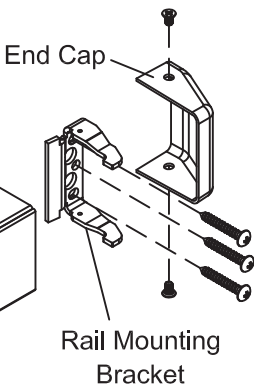

1. PREPARE DOOR AND MOUNT LOCK

Tape templates to inside face and edge of doors according to directions given on template. Drill holes and mortise door for lock as indicated.

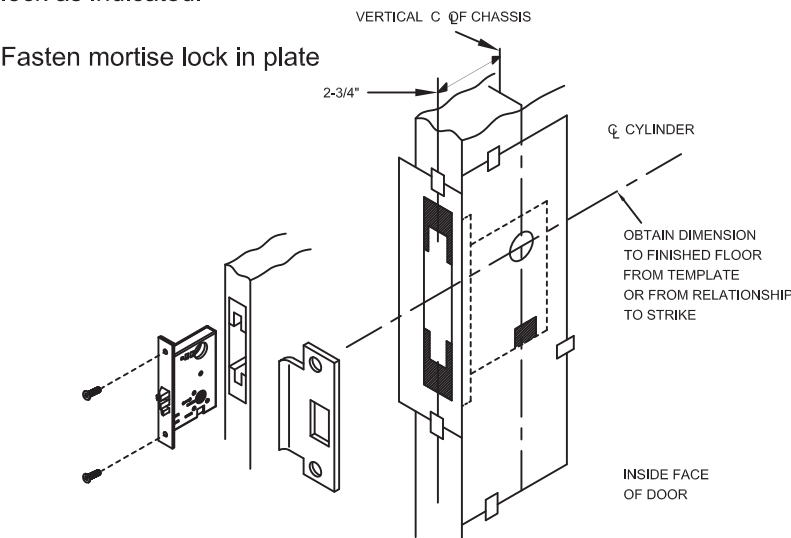

3. APPLY EXTERIOR TRIMS

3.1 If Esc Lever trim is used, attach outside trim and cyl.

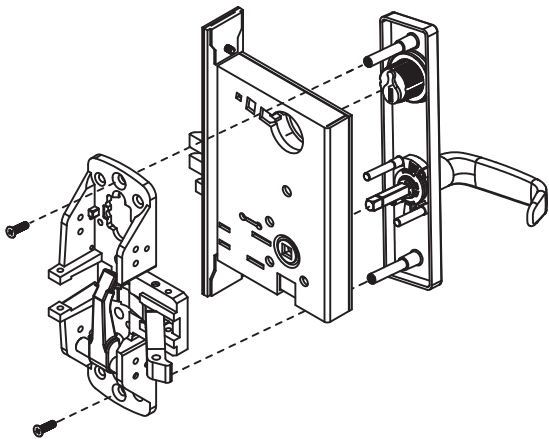

2. ATTACH CHASIS TO DOOR

- 2.1 Attach chasis to Rail, then lock push rail down, using
- 2.2 Position chasis and rail on door, so that lever arm is under rear section of Mortise lock lever. Then lift up until latchbolt is completely retracted.
- 2.3 With chasis in this position and rail horizontal, mark location of chasis mounting holes. Drill holes for screws.
- 2.4 Release Push rail, and dis-ass'y chasis from rail. Then, mount chasis on door.

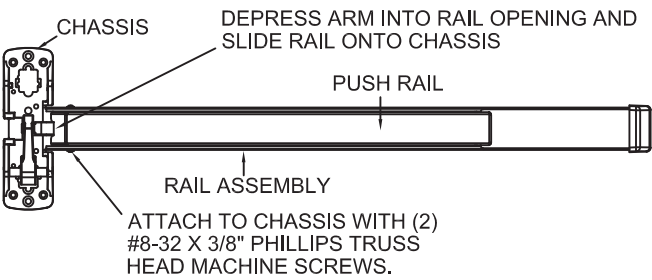

4. MOUNT RAIL ASS'Y

4.1 Determine cut-off dimension "X" by subtracting 1-1/8" from dimension "Y"

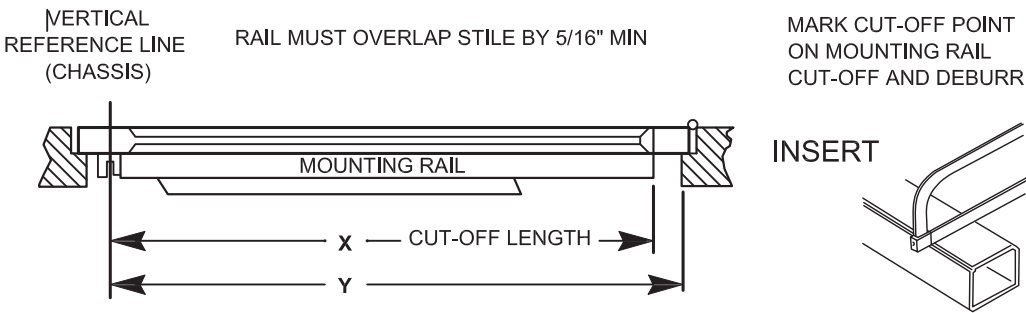

5. ATTACH COVER

- Attach cover to chasis with four cover screws

