

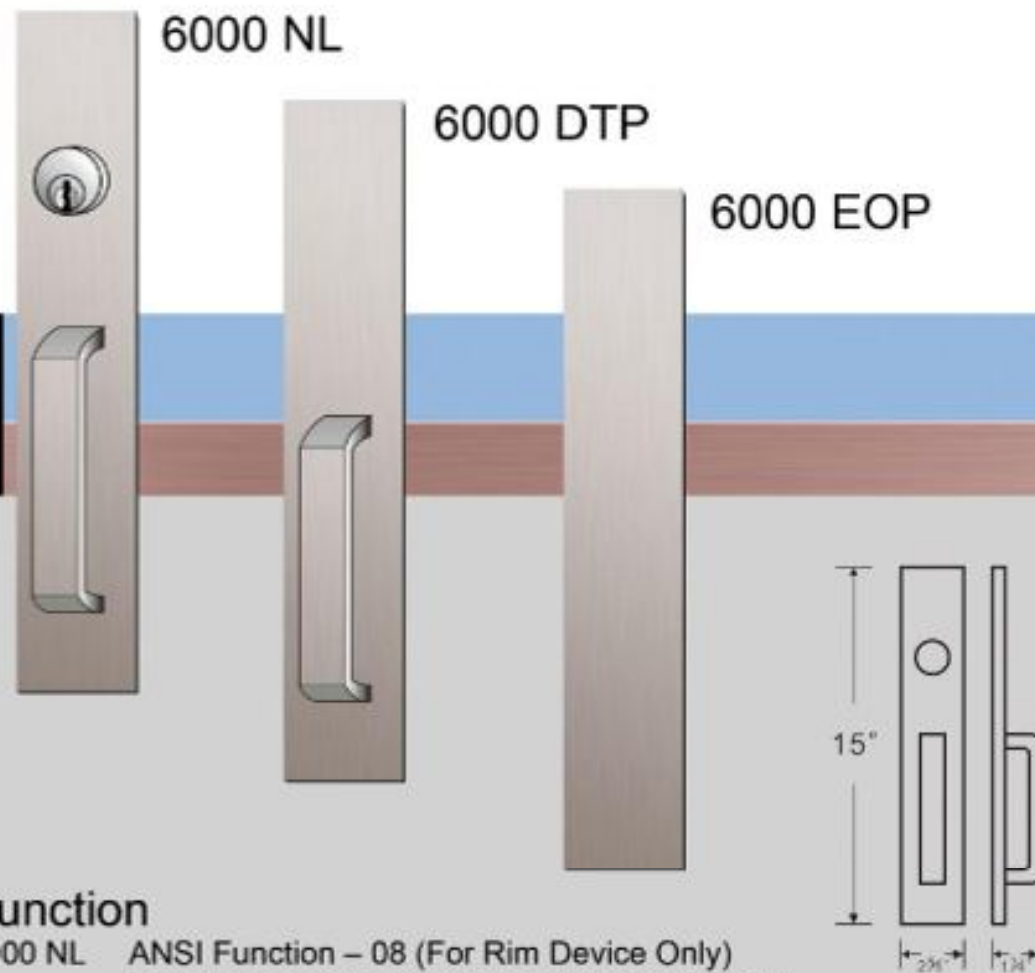

Panic Hardware

Luter Fire Command Panic Exit Device Pull for Exit Device Outside Trim



Function

6000 NL ANSI Function - 08 (For Rim Device Only)
Thumbpiece trim, night latch with Rim Cylinder.
Keyway:
Standard 6-pin Schlage "C" keyway. Also
available in Corbin 60, Sargent LA, and
Mul-T-Lock high security cylinders.

6000 DTP ANSI Function - 02
Pull Trim, Dummy, w/o Cylinder.

6000 EOP ANSI Function - 10
Cover plate only.

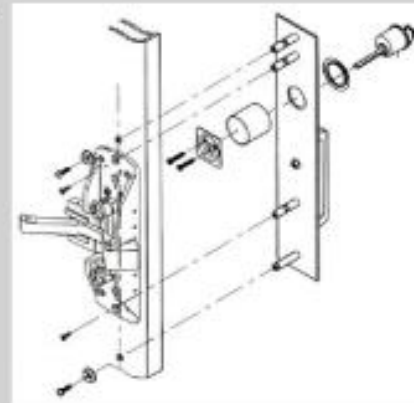

Luter Fire Command Panic Exit Device

Strikes & Accessories

Strikes for using with 6100 Vertical Rod Exit Device

221
Standard for 6100.
Applied to surface of floor
or to a flat threshold.
Standard packaging.

227
Applied to surface of stop.
No mortise required.
Standard packaging.

233
Bottom strike.
Alternate bottom strike.
Flush mounting stainless steel.
Furnished with expansion shields.
Mortise required in the floor.

Strikes for using with 9100 Vertical Rod Fire rated Exit Device

245
For 9000 surface applied.
Standard packaging.

233
Bottom strike for 9000.
Flush mounting stainless steel.
Furnished with expansion shields.
Mortise required in the floor.
Standard packaging.

Strikes for using with 6000 Rim type Exit Device

239
For 6000 surface applied.
Standard packaging.

Strikes for using with 9000 Rim Fire Exit Device

245
For 9000 surface applied.
Standard packaging.

Overlapping Strike

251
Surface applied. Used
on inactive leaf for
device on active leaf of
pair of doors without
mullion.

Additional Strike

LFF
Lock front filler.

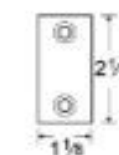

SF
Strike filler

